

# CLASS 150 FLANGES

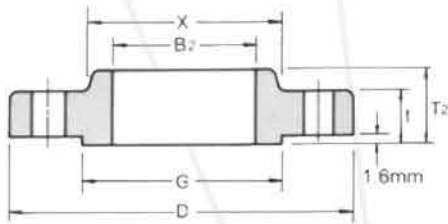

SLIP-ON

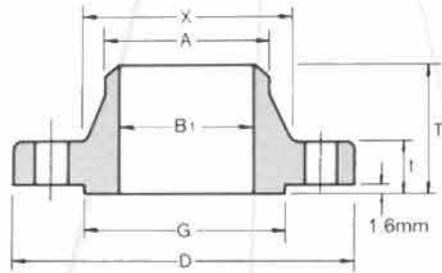

WELDING NECK

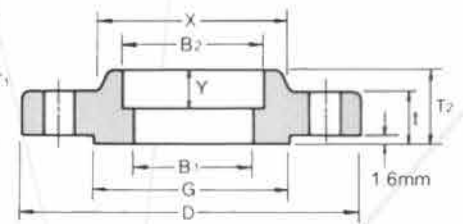

SOCKET WELDING

## ANSI B16.5 FORGED FLANGES

Unit : mm

Nominal Pipe Size	Outside Diam.	O.D. of Raised Face	Diam. of Base of Hub	Thick-ness	BORE			LENGTH THRU HUB			Diam. of Hub at Bevel	Radius of Fillet	Thread Length
					Welding Neck Socket Welding	Slip-on Socket Welding	Lap Joint	Welding Neck	Slip-on Threaded Socket Welding	Lap Joint			
					B <sub>1</sub>	B <sub>2</sub>	B <sub>3</sub>	T <sub>1</sub>	T <sub>2</sub>	T <sub>3</sub>			
D	G	X	t	B <sub>1</sub>	B <sub>2</sub>	B <sub>3</sub>	T <sub>1</sub>	T <sub>2</sub>	T <sub>3</sub>	A	R	Q	
1	89	35.1	30.2	11.2	15.7	22.4	22.9	47.8	15.7	15.7	21.3	3.0	15.7
	99	42.9	38.1	12.7	20.8	27.7	28.2	52.3	15.7	15.7	26.7	3.0	15.7
	108	50.8	49.3	14.2	26.7	34.5	35.1	55.6	17.5	17.5	33.5	3.0	17.5
2	117	63.5	58.7	15.7	35.1	43.2	43.7	57.2	20.6	20.6	42.2	4.8	20.6
	127	73.2	65.0	17.5	40.9	49.5	50.0	62.0	22.4	22.4	48.3	6.4	22.4
	152	91.9	77.7	19.1	52.6	62.0	62.5	63.5	25.4	25.4	60.5	7.9	25.4
3	178	104.6	90.4	22.4	62.7	74.7	75.4	69.9	28.4	28.4	73.2	7.9	28.4
	191	127.0	108.0	23.9	78.0	90.7	91.4	69.9	30.2	30.2	88.9	9.7	30.2
	216	139.7	122.2	23.9	90.2	103.4	104.1	71.4	31.8	31.8	101.6	9.7	31.8
4	229	157.2	134.9	23.9	102.4	116.1	116.8	76.2	33.3	33.3	114.3	11.2	33.3
	254	185.7	163.6	23.9	128.3	143.8	144.5	88.9	36.6	36.6	141.2	11.2	36.6
	279	215.9	192.0	25.4	154.2	170.7	171.5	88.9	39.6	39.6	168.4	12.7	39.6
8	343	269.7	246.1	28.4	202.7	221.5	222.3	101.6	44.5	44.5	219.2	12.7	44.5
	406	323.9	304.8	30.2	254.5	276.4	277.4	101.6	49.3	49.3	273.1	12.7	49.3
	483	381.0	365.3	31.8	304.8	327.2	328.2	114.3	55.6	55.6	323.9	12.7	55.6
14	533	412.8	400.1	35.1	336.6	359.2	360.2	127.0	57.2	79.2	355.6	12.7	57.2
	597	469.9	457.2	36.6	387.4	410.5	411.2	127.0	63.5	87.4	406.4	12.7	63.5
	635	533.4	505.0	39.6	438.2	461.8	462.3	139.7	68.3	96.8	457.2	12.7	68.3
20	699	584.2	558.8	42.9	489.0	513.1	514.4	144.5	73.2	103.1	508.0	12.7	73.2
	813	692.2	663.4	47.8	590.6	616.0	616.0	152.4	82.6	111.3	609.6	12.7	82.6

**Notes :**

- (1) For the 'Bore' (1) other Standard Wall Thickness, refer to page 54.
- (2) Class 150 flanges except Lap Joint will be furnished with 0.06" (1.6mm) raised face, which is included in 'Thickness' (t) and 'Length through Hub' (T<sub>1</sub>), (T<sub>2</sub>)
- (3) For Slip-on, Threaded, Socket Welding and Lap Joint Flanges, the hubs can be shaped either vertical from base to top or tapered within the limits of 7 degrees.

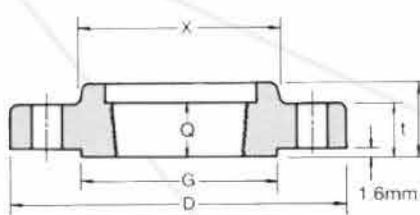

**THREADED**

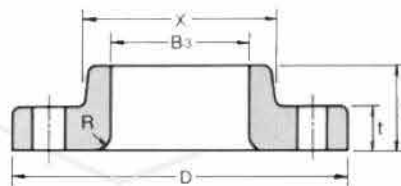

**LAP JOINT**

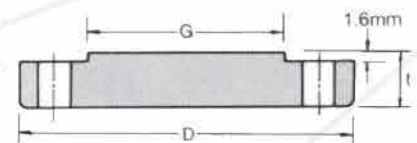

**BLIND**

## ANSI B16.5 FORGED FLANGES

Unit : mm

Nominal Pipe Size	Depth of Socket Y	DRILLING			BOLTING			APPROXIMATE WEIGHT										
		Bolt Circle Diam	Number of Holes	Diam of Holes	Diam of Bolts (inch)	Machine Bolt Length	Stud Bolt Length		Welding Neck		Slip-on and Threaded		Lap Joint		Blind		Socket Welding	
							Raised Face	Ring Joint	Kg	lb	Kg	lb	Kg	lb	Kg	lb	Kg	lb
1	9.7	60.5	4	15.7	1/2	50.8	57.2	—	0.51	1.10	0.47	1.00	0.51	1.00	0.47	1.00	0.47	1.00
	11.2	69.9	4	15.7	1/2	50.8	63.5	—	0.73	1.60	0.58	1.30	0.64	1.40	0.63	1.40	0.59	1.30
	12.7	79.2	4	15.7	1/2	57.2	63.5	76.2	1.07	2.40	0.86	1.90	0.93	1.80	0.94	2.10	0.87	1.90
1 1/2	14.2	88.9	4	15.7	1/2	57.2	69.9	82.6	1.40	3.10	1.08	2.40	1.16	2.00	1.23	2.70	1.11	2.40
	15.7	98.6	4	15.7	1/2	63.5	69.9	82.6	1.81	4.00	1.41	3.10	1.51	3.30	1.62	3.60	1.45	3.20
	17.5	120.7	4	19.1	3/8	69.9	82.6	95.3	2.59	5.70	2.26	5.00	2.38	5.20	2.64	5.80	2.33	5.00
2	19.1	139.7	4	19.1	5/8	76.2	88.9	101.6	4.28	9.40	3.43	7.60	3.60	7.90	4.06	9.00	3.55	7.80
	20.6	152.4	4	19.1	5/8	76.2	88.9	101.6	5.18	11.40	3.87	8.50	4.04	8.90	4.90	10.80	4.02	8.90
	22.4	177.8	8	19.1	5/8	76.2	88.9	101.6	5.45	12.00	4.99	11.00	4.99	11.00	5.90	13.00	4.99	11.00
2 1/2	23.9	190.5	8	19.1	5/8	76.2	88.9	101.6	7.32	16.10	5.75	12.70	5.96	13.00	7.41	16.30	5.99	13.20
	23.9	215.9	8	22.4	3/4	82.6	95.3	108.0	8.91	19.60	6.22	13.70	6.44	14.00	8.76	19.30	6.68	14.70
	26.9	241.3	8	22.4	3/4	82.6	101.6	114.3	11.26	24.80	7.38	16.30	7.59	16.70	11.31	24.90	7.99	17.60
3	31.8	298.5	8	22.4	3/4	88.9	108.0	120.7	17.68	39.00	12.36	27.30	12.66	27.90	19.92	43.90	13.29	29.30
	33.3	362.0	12	25.4	7/8	101.6	114.3	127.0	24.79	54.70	17.10	37.70	16.78	37.00	29.39	64.80	19.50	43.00
	39.6	431.8	12	25.4	7/8	101.6	120.7	133.4	38.98	85.90	27.68	61.00	28.30	62.40	43.70	96.30	29.03	64.00
4	41.4	476.3	12	28.4	1	114.3	133.4	146.1	51.71	114.00	35.20	77.60	41.50	91.50	59.42	140.00	38.56	85.00
	44.5	539.8	16	28.4	1	114.3	133.4	146.1	64.41	142.00	42.18	93.00	52.98	116.80	77.11	170.00	44.49	98.00
	49.3	577.9	16	31.8	1 1/8	127.0	146.1	158.8	74.84	165.00	49.71	109.60	59.00	130.00	94.80	209.00	54.43	120.00
20	54.1	635.0	20	31.8	1 1/4	139.7	158.8	171.5	89.36	197.00	65.50	140.00	72.12	159.00	123.38	272.00	70.31	155.00
	63.5	749.3	20	35.1	1 1/4	152.4	171.5	184.2	119.66	263.80	90.50	199.50	99.02	218.30	188.24	415.00	95.25	210.00

(4) Blind Flanges may be made with the same hub as that used for Slip-on Flanges or without hub.

(5) The gasket surface and backside (bearing surface for bolting) are made parallel within 1 degree. To accomplish parallelism, spot facing is carried out according to MSS SP-9, without reducing thickness(t).

(6) Depth of Socket (Y) is covered by ANSI B16.5 only in sizes through 3 inch, over 3 inch is at the manufacturer's option.

# CLASS 300 FLANGES

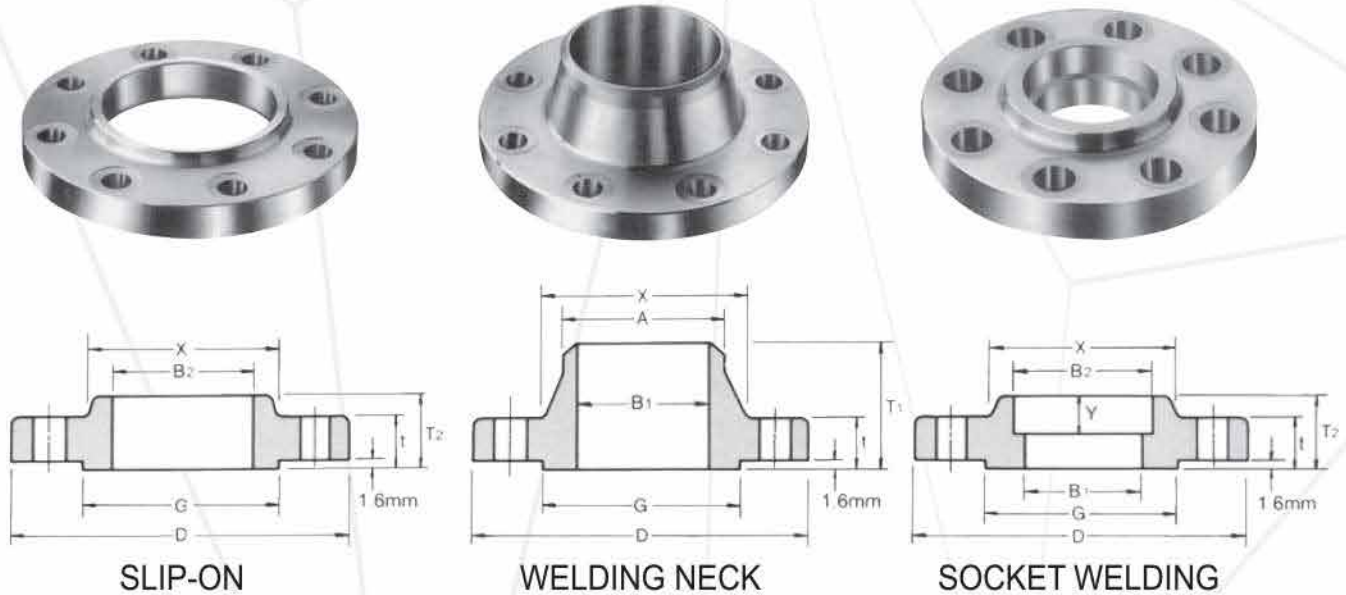

## ANSI B16.5 FORGED FLANGES

Unit : mm

Nominal Pipe Size	Outside Diam.	Diam. at Base of Hub	O.D. of Raised Face	Thick-ness	BORE				LENGTH THRU HUB			Diam. of Hub at Bevel	Radius of Fillet	Thread Length
					Welding Neck Socket Welding	Slip-on Socket Welding	Lap Joint	Counter Bore Min. Threaded Min.	Welding Neck	Slip-on Threaded Socket Welding	Lap Joint			
					B <sub>1</sub>	B <sub>2</sub>	B <sub>3</sub>	B	T <sub>1</sub>	T <sub>2</sub>	T <sub>3</sub>			
D	X	G	t	B <sub>1</sub>	B <sub>2</sub>	B <sub>3</sub>	B	T <sub>1</sub>	T <sub>2</sub>	T <sub>3</sub>	A	R	Q	
½	95	38.1	35.1	14.2	15.7	22.4	22.9	23.6	52.3	22.4	22.4	21.3	3.0	15.7
¾	117	47.8	42.9	15.7	20.8	27.7	28.2	29.0	57.2	25.4	25.4	26.7	3.0	15.7
1	124	53.8	50.8	17.5	26.7	34.5	35.1	35.8	62.0	26.9	26.9	33.5	3.0	17.5
1¼	133	63.5	63.5	19.1	35.1	43.2	43.7	44.5	65.0	26.9	26.9	42.2	4.8	20.6
1½	155	69.9	73.2	20.6	40.9	49.5	50.0	50.5	68.3	30.2	30.2	48.3	6.4	22.4
2	165	84.1	91.9	22.4	52.6	62.0	62.5	63.5	69.9	33.3	33.3	60.5	7.9	28.4
2½	191	100.1	104.6	25.4	62.7	74.7	75.4	76.2	76.2	38.1	38.1	73.2	7.9	31.8
3	210	117.3	127.0	28.4	78.0	90.7	91.4	92.2	79.2	42.9	42.9	88.9	9.7	31.8
3½	229	133.4	139.7	30.2	90.2	103.4	104.1	104.9	81.0	44.5	44.5	101.6	9.7	36.6
4	254	146.1	157.2	31.8	102.4	116.1	116.8	117.6	85.9	47.8	47.8	114.3	11.2	36.6
5	279	177.8	185.7	35.1	128.3	143.8	144.5	144.5	98.6	50.8	50.8	141.2	11.2	42.9
6	318	206.2	215.9	36.6	154.2	170.7	171.5	171.5	98.6	52.3	52.3	168.4	12.7	46.0
8	381	260.4	269.7	41.1	202.7	221.5	222.3	222.3	111.3	62.0	62.0	219.2	12.7	50.8
10	445	320.5	323.9	47.8	254.5	276.4	277.4	276.4	117.3	66.5	95.3	273.1	12.7	55.6
12	521	374.7	381.0	50.8	304.8	327.2	328.2	328.7	130.0	73.2	101.6	323.9	12.7	60.5
14	584	425.5	412.8	53.8	336.6	359.2	360.2	360.4	142.7	76.2	111.3	355.6	12.7	63.5
16	648	482.6	469.9	57.2	387.4	410.5	411.2	411.2	146.1	82.6	120.7	406.4	12.7	68.3
18	711	533.4	533.4	60.5	438.2	461.8	462.3	462.0	158.8	88.9	130.0	457.2	12.7	69.9
20	775	587.2	584.2	63.5	489.0	513.1	514.4	512.8	162.1	95.3	139.7	508.0	12.7	73.2
24	914	701.5	692.2	69.9	590.6	616.0	616.0	614.4	168.1	106.4	152.4	609.6	12.7	82.6

**Notes :**

- (1) For the 'Bore' (B<sub>1</sub>) other than Standard Wall Thickness
- (2) Class 300 flanges except Lap Joint will be furnished with 0.06" (1.6mm) raised face, which is included in 'Thickness' (t) and 'Length through Hub' (T<sub>1</sub>), (T<sub>2</sub>)
- (3) For Slip-on, Threaded, Socket Welding and Lap Joint Flanges, the hubs can be shaped either vertical from base to or tapered within the limits of 7 degrees.

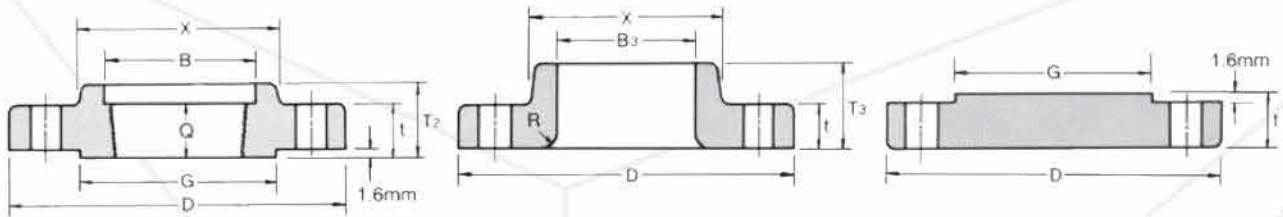

**THREADED**

**LAP JOINT**

**BLIND**

Unit : mm

Nominal Pipe Size	Depth of Socket Y	DRILLING			BOLTING				APPROXIMATE WEIGHT									
		Bolt Circle Diam	Number of Holes	Diam of Holes	Diam of Bolts (inch)	Machine Bolt Length	Stud Bolt Length		Welding Neck		Slip-on and Threaded		Lap Joint		Blind		Socket Welding	
							Raised Face	Ring Joint	Kg	lb	Kg	lb	Kg	lb	Kg	lb	Kg	lb
1	9.7	66.5	4	15.7	1/2	57.2	63.5	76.2	0.78	1.70	0.62	1.40	0.61	1.30	0.62	1.40	0.62	1.40
	11.2	82.6	4	19.1	5/8	63.5	76.2	88.9	1.34	3.00	1.15	2.50	1.15	2.50	1.16	2.50	1.19	2.60
	12.7	88.9	4	19.1	5/8	63.5	76.2	88.9	1.64	3.60	1.39	3.10	1.38	3.00	1.42	3.00	1.44	3.20
2	14.2	98.6	4	19.1	5/8	69.9	82.6	95.3	2.06	4.50	1.67	3.70	1.66	3.70	1.79	3.90	1.73	3.80
	15.7	114.3	4	22.4	3/4	76.2	88.9	101.6	3.06	6.70	2.53	5.60	2.52	5.60	2.68	5.90	2.62	5.80
	17.5	127.0	8	19.1	5/8	76.2	88.9	101.6	3.40	7.50	2.80	6.20	2.79	6.20	3.09	6.80	2.94	6.50
3	19.1	149.4	8	22.4	3/4	82.6	101.6	114.3	5.31	11.70	4.25	9.40	4.22	9.30	4.75	10.50	4.49	9.90
	20.6	168.1	8	22.4	3/4	88.9	108.0	120.7	7.32	16.10	5.81	12.80	5.78	12.70	6.79	14.90	6.20	13.70
	22.4	184.2	8	22.4	3/4	95.3	108.0	127.0	8.17	18.00	7.72	17.00	7.72	17.00	9.53	21.00		
4	23.9	200.2	8	22.4	3/4	95.3	114.3	127.0	11.30	24.90	10.13	22.30	10.07	22.20	12.00	26.50		
	23.9	235.0	8	22.4	3/4	108.0	120.7	133.4	15.12	33.30	12.58	27.70	12.52	27.60	15.96	35.20		
	26.9	269.7	12	22.4	3/4	108.0	120.7	139.7	19.68	43.40	16.04	35.40	15.95	35.20	21.20	46.70		
8	31.8	330.2	12	25.4	7/8	120.7	139.7	152.4	30.48	67.20	24.50	54.00	24.37	53.70	34.60	76.30		
	33.3	387.4	16	28.4	1	139.7	158.8	171.5	43.74	96.40	34.16	75.30	39.92	88.00	55.34	122.00		
	39.6	450.9	16	31.8	1 1/8	146.1	171.5	184.2	64.41	142.00	51.26	113.00	58.70	129.40	78.90	174.00		
14	41.4	514.4	20	31.8	1 1/8	158.8	177.8	190.5	88.30	194.70	72.12	159.00	83.46	184.00	107.05	236.00		
	44.5	571.5	20	35.1	1 1/4	165.1	190.5	203.2	112.94	249.00	90.40	199.30	106.14	234.00	139.25	307.00		
	49.3	628.7	24	35.1	1 1/4	171.5	196.9	209.6	138.34	305.00	109.00	240.30	133.95	295.30	176.90	396.00		
20	54.1	685.8	24	35.1	1 1/4	184.2	203.2	222.3	167.37	369.00	136.00	300.00	157.65	347.60	223.17	492.00		
	63.5	812.8	24	41.1	1 1/2	203.2	228.6	254.0	235.41	519.00	204.00	449.70	240.40	530.00	342.00	754.00		

(4) Blind Flanges may be made with the same hub as that used for Slip-on Flanges or without hub.

(5) The gasket surface and backside (bearing surface for bolting) are made parallel within 1 degree. To accomplish parallelism, spot facing is carried out according to MSS SP-9, without reducing thickness(t).

(6) Depth of Socket (Y) is covered by ANSI B16.5 only is sizes through 3 inch, over 3 inch is at the manufacturer's option

# CLASS 400 FLANGES

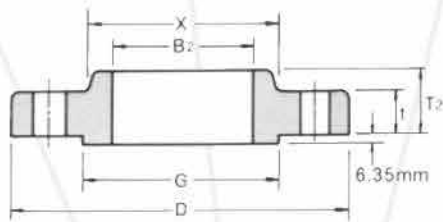

SLIP-ON

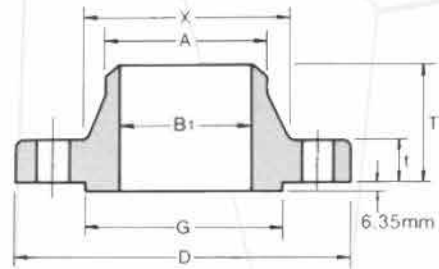

WELDING NECK

## ANSI B16.5 FORGED FLANGES

Unit : mm

Nominal Pipe Size	Outside Diam.	Diam. at Base of Hub	O.D. of Raised Face	Thick-ness	BORE				LENGTH THRU HUB			Diam. of Hub: at Bevel
					Welding Neck	Slip-on	Lap Joint	Counter Bore Min.	Welding Neck	Slip-on and Threaded	Lap Joint	
					B <sub>1</sub>	B <sub>2</sub>	B <sub>3</sub>	B	T <sub>1</sub>	T <sub>2</sub>	T <sub>3</sub>	
1	95	38.1	35.1	14.2	See Note(1) To be specified by purchaser.	22.4	22.9	23.6	52.3	22.4	22.4	21.3
	117	47.8	42.9	15.7		27.7	28.2	29.0	57.2	25.4	25.4	26.7
	124	53.8	50.8	17.5		34.5	35.1	35.8	62.0	26.9	26.9	33.5
1 1/4	133	63.5	63.5	20.6		43.2	43.7	44.5	66.5	28.4	28.4	42.2
2 1/2	155	69.9	73.2	22.4		49.5	50.0	50.5	69.9	31.8	31.8	48.3
	165	84.1	91.9	25.4		62.0	62.5	63.5	73.2	36.6	36.6	60.5
2 1/2	191	100.1	104.6	58.4		74.7	75.4	76.2	79.2	41.1	41.1	73.2
3	210	117.3	127.0	31.8		90.7	91.4	92.2	82.6	46.0	46.0	88.9
	229	133.4	139.7	35.1		103.4	104.1	104.9	85.9	49.3	49.3	101.6
4	254	146.1	157.2	35.1		116.1	116.8	117.6	88.9	50.8	50.8	114.3
5	279	177.8	185.7	38.1		143.8	144.5	144.5	101.6	53.8	53.8	141.2
6	318	206.2	215.9	41.1		170.7	171.5	171.5	103.1	57.2	57.2	168.4
8	381	260.4	269.7	47.8	221.5	222.3	222.3	117.3	68.3	68.3	219.2	
10	445	320.5	323.9	53.8	276.4	277.4	276.4	124.0	73.2	101.6	273.1	
12	521	374.7	381.0	57.2	327.2	328.2	328.7	136.7	79.2	108.0	323.9	
14	584	425.5	412.8	60.5	359.2	360.2	360.4	149.4	84.1	117.3	355.6	
16	648	482.6	469.9	63.5	410.5	411.2	411.2	152.4	93.7	127.0	406.4	
18	711	533.4	533.4	66.5	461.8	462.3	462.0	165.1	98.6	136.7	457.2	
20	775	587.2	584.2	69.9	513.1	514.4	512.8	168.1	101.6	146.1	508.0	
24	914	701.5	692.2	76.2	616.0	616.0	614.4	174.8	114.3	158.8	609.6	

**Notes :**

- (1) For the inside diameter of pipes (corresponding to 'Bore' (B<sub>1</sub>) of Welding Neck Flanges)
- (2) Class 400 flanges except Lap Joint will be furnished with 0.25" (6.35mm) raised face which is not included in 'Thickness' (t) and 'Length through Hub' (T<sub>1</sub>), (T<sub>2</sub>).
- (3) For Slip-on, Threaded and Lap Joint Flanges, the hubs can be shaped either vertical from base to top or tapered within the limits of 7 degrees.

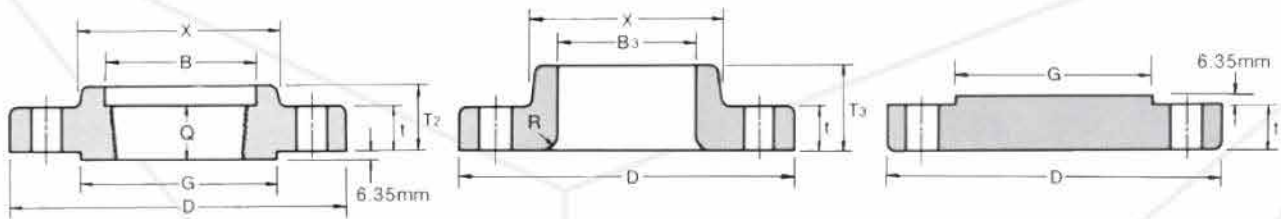

**THREADED**

**LAP JOINT**

**BLIND**

Unit : mm

Nominal Pipe Size	Radius of Fillet	Thread Length	DRILLING			BOLTING				APPROXIMATE WEIGHT							
						Stud Bolt Length			Welding Neck		Slip-on and Threaded		Lap Joint		Blind		
			Bolt Circle Diam	Number of Holes	Diam of Holes	Diam of Bolts (inch)	0.25" Raised Face	Male-Female Tongue-Groove	Ring Joint	Kg	lb	Kg	lb	Kg	lb	Kg	lb
1	3.0	15.7	66.5	4	15.7	1/2	76.2	69.9	76.2	1.36	3.00	0.91	2.00	0.80	1.80	0.91	2.00
	3.0	15.7	82.6	4	19.1	5/8	88.9	82.6	88.9	1.59	3.50	1.36	3.00	1.36	3.00	1.40	3.00
	3.0	17.5	88.9	4	19.1	5/8	88.9	82.6	88.9	1.81	4.00	1.59	3.50	1.59	3.50	1.70	3.80
1 1/4	4.8	20.6	98.6	4	19.1	5/8	95.3	88.9	95.3	2.50	5.50	2.10	4.60	2.04	4.50	2.27	5.00
	6.4	22.4	114.3	4	22.4	3/4	108.0	101.6	108.0	3.63	8.00	3.10	6.80	2.95	6.50	3.40	7.50
2	7.9	28.4	127.0	8	19.1	5/8	108.0	101.6	108.0	4.54	10.00	3.63	8.00	3.63	8.00	4.40	9.70
	7.9	31.8	149.4	8	22.4	3/4	120.7	114.3	120.7	6.35	14.00	5.44	12.00	4.99	11.00	6.80	15.00
3	9.7	35.1	168.1	8	22.4	3/4	127.0	120.7	127.0	8.17	18.00	7.26	16.00	6.35	14.00	8.90	19.60
	9.7	39.6	184.2	8	25.4	7/8	139.7	133.4	139.7	11.80	26.00	9.53	21.00	9.08	20.00	13.17	29.00
4	11.2	36.6	200.2	8	25.4	7/8	139.7	133.4	139.7	13.61	30.00	10.89	24.00	9.98	22.00	14.40	31.70
	11.2	42.9	235.0	8	25.4	7/8	146.1	139.7	146.1	17.69	39.00	14.07	31.00	13.15	29.00	19.50	43.00
6	12.7	46.0	269.7	12	25.4	7/8	152.4	146.1	152.4	22.23	49.00	19.98	44.00	16.78	37.00	27.67	61.00
	12.7	50.8	330.2	12	28.4	1	171.5	165.1	171.5	35.38	78.00	30.40	67.00	26.16	59.00	45.36	100.00
10	12.7	55.6	387.4	16	31.8	1 1/8	190.5	184.2	190.5	49.89	110.00	41.28	91.00	43.09	95.00	68.00	150.00
	12.7	60.5	450.9	16	35.1	1 1/4	203.2	196.9	203.2	72.57	160.00	59.02	130.00	68.95	152.00	98.00	216.00
14	12.7	63.5	514.4	20	35.1	1 1/4	209.6	203.2	209.6	105.69	233.00	81.72	180.00	95.25	210.00	131.66	290.00
16	12.7	68.3	571.5	20	38.1	1 3/8	222.3	215.9	222.3	133.30	294.00	106.69	235.00	127.00	280.00	167.00	368.00
18	12.7	69.9	628.7	24	38.1	1 3/8	228.6	222.3	228.6	158.90	350.30	129.39	285.30	156.49	345.00	206.57	455.40
20	12.7	73.2	685.8	24	41.1	1 1/2	241.3	235.0	247.7	193.00	425.50	152.00	335.00	190.51	420.00	261.00	575.40
24	12.7	82.6	812.8	24	47.8	1 3/4	266.7	260.4	279.4	281.48	620.50	231.54	510.50	278.96	615.00	395.00	870.80

- (4) Blind Flanges may be made with the same hub as that used for Slip-on Flanges or without hub.
- (5) The gasket surface and backside (bearing surface for bolting) are made parallel within 1 degree. To accomplish parallelism, spot facing is carried out according to MSS SP-9, without reducing thickness(t).
- (6) Dimensions of size 1/2" through 3 1/2" are the same as for Class 600 Flanges.

# CLASS 600 FLANGES

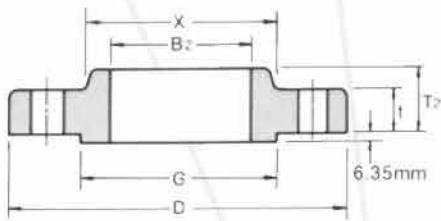

SLIP-ON

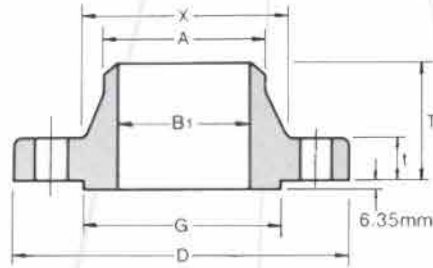

WELDING NECK

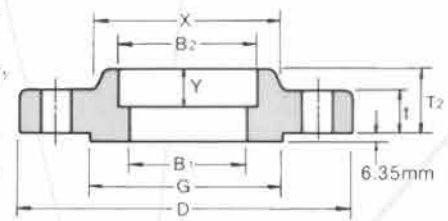

SOCKET WELDING

## ANSI B16.5 FORGED FLANGES

Unit : mm

Nominal Pipe Size	Outside Diam.	Diam. at Base of Hub	O.D. of Raised Face	Thick-ness	BORE				LENGTH THRU HUB			Diam. of Hub at Bevel	Radius of Fillet	Thread Length
					Welding Neck Socket Welding	Slip-on Socket Welding	Lap Joint	Counter Bore Min.	Welding Neck	Slip-on Threaded Socket Welding	Lap Joint			
					B <sub>1</sub>	B <sub>2</sub>	B <sub>3</sub>	B	T <sub>1</sub>	T <sub>2</sub>	T <sub>3</sub>			
1/2	95	38.1	35.1	14.2	See Note(1) To be specified by purchaser.	22.4	22.9	23.6	52.3	22.4	22.4	21.3	3.0	15.7
3/4	117	47.8	42.9	15.7		27.7	28.2	29.0	57.2	25.4	25.4	26.7	3.0	15.7
1	124	53.8	50.8	17.5		34.5	35.1	35.8	62.0	26.9	26.9	33.5	3.0	17.5
1 1/4	133	63.5	63.5	20.6		43.2	43.7	44.5	66.5	28.4	28.4	42.2	4.8	20.6
1 1/2	155	69.9	73.2	22.4		49.5	50.0	50.5	69.9	31.8	31.8	48.3	6.4	22.4
2	165	84.1	91.9	25.4		62.0	62.5	63.5	73.2	36.6	36.6	60.5	7.9	28.4
2 1/2	191	100.1	104.6	28.4		74.7	75.4	76.2	79.2	41.1	41.1	73.2	7.9	31.8
3	210	117.3	127.0	31.8		90.7	91.4	92.2	82.6	46.0	46.0	88.9	9.7	35.1
3 1/2	229	133.4	139.7	35.1		103.4	104.1	104.9	85.9	49.3	49.3	101.6	9.7	39.6
4	273	152.4	157.2	38.1		116.1	116.8	117.6	101.6	53.8	53.8	114.3	11.2	41.1
5	330	189.0	185.7	44.5		143.8	144.5	144.5	114.3	60.5	60.5	141.2	11.2	47.8
6	356	222.3	215.9	47.8		170.7	171.5	171.5	117.3	66.5	66.5	168.4	12.7	50.8
8	419	273.1	269.7	55.6		221.5	222.3	222.3	133.4	76.2	76.2	219.2	12.7	57.2
10	508	342.9	323.9	63.5		276.4	277.4	276.4	152.4	85.9	111.3	273.1	12.7	65.0
12	559	400.1	381.0	66.5		327.2	328.2	328.7	155.4	91.9	117.3	323.9	12.7	69.9
14	603	431.8	412.8	69.9		359.2	360.2	360.4	165.1	93.7	127.0	355.6	12.7	73.2
16	686	495.3	469.9	76.2		410.5	411.2	411.2	177.8	106.4	139.7	406.4	12.7	77.7
18	743	546.1	533.4	82.6		461.8	462.3	462.0	184.2	117.3	152.4	457.2	12.7	79.2
20	813	609.6	584.2	88.9		513.1	514.4	512.8	190.5	127.0	165.1	508.0	12.7	82.6
24	940	717.6	692.2	101.6		616.0	616.0	614.4	203.2	139.7	184.2	609.6	12.7	91.9

**Notes :**

- (1) For the inside diameter of pipes (corresponding to 'Bore' (B<sub>1</sub>) of Welding Neck Flanges)
- (2) Class 600 flanges except Lap Joint will be furnished with 0.25" (0.35mm) raised face, which is not included in 'Thickness' (t) and 'Length through Hub' (T<sub>1</sub>), (T<sub>2</sub>)
- (3) For Slip-on, Threaded, Lap Joint and Socket Welding Flanges, the hubs can be shaped either vertical from base to top or tapered within the limits of 7 degrees.

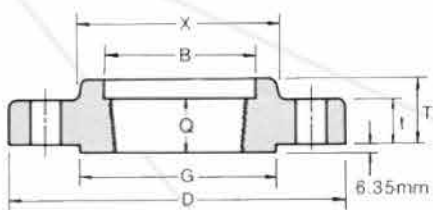

**THREADED**

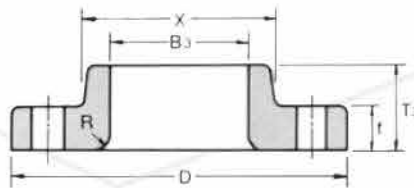

**LAP JOINT**

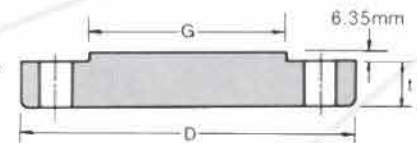

**BLIND**

Unit : mm

Nominal Pipe Size	Depth of Socket Y	DRILLING			BOLTING				APPROXIMATE WEIGHT									
					Stud Bolt Length			Welding Neck	Slip-on and Threaded		Lap Joint		Blind		Socket Welding			
		Bolt Circle Diam	Number of Holes	Diam of Holes	Diam of Bolts (inch)	0.25" Raised Face	Male-Female Tongue-Groove										Ring Joint	Kg
1/2	9.7	66.5	4	15.7	1/2	76.2	69.9	76.2	0.90	2.00	0.91	2.00	0.80	1.80	0.91	2.00	0.91	2.00
3/4	11.2	82.6	4	19.1	5/8	88.9	82.6	88.9	1.59	3.50	1.40	3.00	1.36	3.00	1.40	3.00	1.36	3.00
1	12.7	88.9	4	19.1	3/4	88.9	82.6	88.9	1.90	4.00	1.70	3.70	1.59	3.50	1.81	4.00	1.81	4.00
1 1/4	14.2	98.6	4	19.1	7/8	95.3	88.9	95.3	2.49	5.50	2.27	5.00	2.04	4.50	2.40	5.30	2.60	5.70
1 1/2	15.7	114.3	4	22.4	1	108.0	101.6	108.0	3.63	8.00	3.10	6.80	2.95	6.50	3.40	7.50	3.18	7.00
2	17.5	127.0	8	19.1	1	108.0	101.6	108.0	4.54	10.00	3.63	8.00	3.63	8.00	4.40	9.70	3.90	8.60
2 1/2	19.1	149.4	8	22.4	1 1/8	120.7	114.3	120.7	6.35	14.00	5.44	12.00	4.99	11.00	6.80	15.00	5.90	13.00
3	20.6	168.1	8	22.4	1 1/8	127.0	120.7	127.0	8.16	18.00	7.26	16.00	6.35	14.00	8.90	19.60	7.40	16.30
3 1/2	22.4	184.2	8	25.4	1 1/4	139.7	133.4	139.7	11.80	26.00	9.53	21.00	9.08	20.00	13.17	29.00		
4	23.9	215.9	8	25.4	1 1/4	146.1	139.7	146.1	16.78	37.00	14.97	33.00	14.06	31.00	18.60	41.00		
5	23.9	266.7	8	28.4	1 1/2	165.1	158.8	165.1	30.87	68.00	28.50	62.80	27.50	60.60	30.84	68.00		
6	26.9	292.1	12	28.4	1 1/2	171.5	165.1	171.5	36.77	80.00	36.32	80.00	35.38	78.00	38.00	83.80		
8	31.8	349.3	12	31.8	1 3/4	190.5	184.2	196.9	50.80	112.00	44.00	97.00	50.80	112.00	62.20	137.00		
10	33.3	431.8	16	35.1	1 3/4	215.9	209.6	215.9	86.26	190.00	76.20	168.00	74.00	163.00	102.00	224.90		
12	39.6	489.0	20	35.1	1 3/4	222.3	215.9	222.3	102.51	226.00	97.52	215.00	108.86	240.00	132.00	291.00		
14	41.4	527.1	20	38.1	1 3/4	235.0	228.6	235.0	121.56	268.00	102.00	224.80	111.00	244.70	158.00	348.30		
16	44.5	603.3	20	41.1	1 3/4	254.0	247.7	254.0	177.06	290.00	149.82	330.20	165.71	365.30	224.73	495.40		
18	49.3	654.1	20	44.5	1 3/4	273.1	266.7	273.1	215.65	475.40	180.10	412.30	194.00	427.70	285.00	628.30		
20	54.1	723.9	24	44.5	1 3/4	285.8	279.4	292.1	267.86	590.50	231.54	510.50	258.78	570.50	365.00	804.70		
24	63.5	838.2	24	50.8	1 3/4	330.2	323.9	336.6	372.00	820.00	330.00	725.50	362.00	798.00	533.45	1176.0		

- (4) Blind Flanges may be made with the same hub as that used for Slip-on Flanges or without hub.
- (5) The gasket surface and backside (bearing surface for bolting) are made parallel within 1 degree. To accomplish parallelism, spot facing is carried out according to MSS SP-9, without reducing thickness(t).
- (6) Dimensions of size 1/2" through 3 1/2" are the same as for Class 400 Flanges.
- (7) Depth of Socket (Y) is covered by ANSI B16.5 only in sizes through 3 inch, over 3 inch is at the manufacturer's option



# CLASS 900 FLANGES

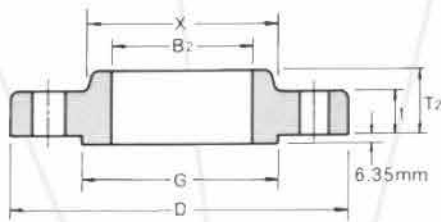

SLIP-ON

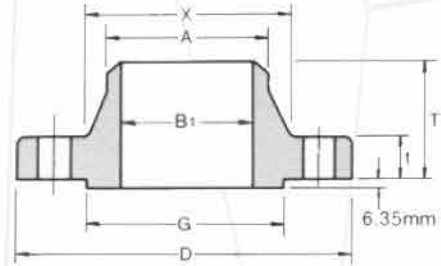

WELDING NECK

## ANSI B16.5 FORGED FLANGES

Unit : mm

Nominal Pipe Size	Outside Diam.	Diam. at Base of Hub	O.D. of Raised Face	Thick-ness	BORE				LENGTH THRU HUB			Diam. of Hub at Bevel
					Welding Neck	Slip-on	Lap Joint	Counter Bore Min.	Welding Neck	Slip-on and Threaded	Lap Joint	
					B <sub>1</sub>	B <sub>2</sub>	B <sub>3</sub>	B	T <sub>1</sub>	T <sub>2</sub>	T <sub>3</sub>	
1/2	121	38.1	35.1	22.4	See Note(1) To be specified by purchaser.	22.4	22.9	23.6	60.5	31.8	31.8	21.3
3/4	130	44.5	42.9	25.4		27.7	28.2	29.0	69.9	35.1	35.1	26.7
1	149	52.3	50.8	28.4		34.5	35.1	35.8	73.2	41.1	41.1	33.5
1 1/4	159	63.5	63.5	28.4		43.2	43.7	44.5	73.2	41.1	41.1	42.2
1 1/2	178	69.9	73.2	31.8		49.5	50.0	50.5	82.6	44.5	44.5	48.3
2	216	104.6	91.9	38.1		62.0	62.5	63.5	101.6	57.2	57.2	60.5
2 1/2	244	124.0	104.6	41.1		74.7	75.4	76.2	104.6	63.5	63.5	73.2
3	241	127.0	127.0	38.1		90.7	91.4	92.2	101.6	53.8	53.8	88.9
4	292	158.8	157.2	44.5		116.1	116.8	117.6	114.3	69.9	69.9	114.3
5	349	190.5	185.7	50.8		143.8	144.5	144.5	127.0	79.2	79.2	141.2
6	381	235.0	215.9	55.6		170.7	171.5	171.5	139.7	85.9	85.9	168.4
8	470	298.5	269.7	63.5		221.5	222.3	222.3	162.1	101.6	114.3	219.2
10	546	368.3	323.9	69.9		276.4	277.4	276.4	184.2	108.0	127.0	273.1
12	610	419.1	381.0	79.2		327.2	328.2	328.7	200.2	117.3	142.7	323.9
14	641	450.9	412.8	85.9		359.2	360.2	360.4	212.9	130.0	155.4	355.6
16	705	508.0	469.9	88.9		410.5	411.2	411.2	215.9	133.4	165.1	406.4
18	787	565.2	533.4	101.6		461.8	462.3	462.0	228.6	152.4	190.5	457.2
20	857	622.3	584.2	105.0		513.1	514.4	512.8	247.7	158.8	209.6	508.0
24	1041	749.3	692.2	139.7		616.0	616.0	614.4	292.1	203.2	266.7	609.6

**Notes :**

- (1) For the inside diameter of pipes (corresponding to 'Bore' (B<sub>1</sub>) of Welding Neck Flanges)
- (2) Class 900 Flanges except Lap Joint will be furnished with 0.25" (6.35mm) raised, face which is not included in 'Thickness' (t) and 'Length through Hub' (T<sub>1</sub>), (T<sub>2</sub>).
- (3) For Slip-on, Threaded and Lap Joint Flanges, the hubs can be shaped either vertical from base to top or tapered within the limits of 7 degrees.

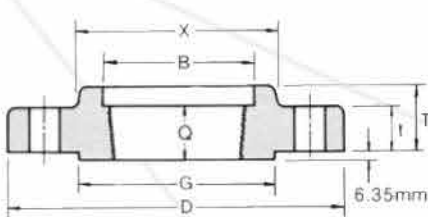

**THREADED**

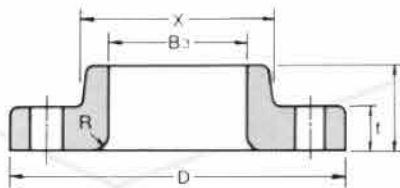

**LAP JOINT**

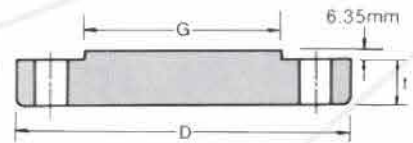

**BLIND**

Unit : mm

Nominal Pipe Size	Radius of Fillet R	Thread Length Q	DRILLING			BOLTING				APPROXIMATE WEIGHT							
						Bolt Circle Diam	Number of Holes	Diam of Holes	Diam of Bolts (inch)	Stud Bolt Length			Welding Neck		Slip-on and Threaded		Lap Joint
			0.25" Raised Face	Male-Female Tongue-Groove	Ring Joint					Kg	lb	Kg	lb	Kg	lb	Kg	lb
1/2	3.0	22.4	82.6	4	22.4	3/4	108.0	101.6	108.0	2.10	4.60	1.81	4.00	1.81	4.00	1.90	4.20
3/4	3.0	25.4	88.9	4	22.4	3/4	114.3	108.0	114.3	2.72	6.00	2.40	5.30	2.30	5.00	2.70	6.00
1	3.0	28.4	101.6	4	25.4	7/8	127.0	120.7	127.0	3.86	8.50	3.41	7.50	3.40	7.50	4.09	9.00
1 1/4	4.8	30.2	111.3	4	25.4	7/8	127.0	120.7	127.0	4.54	10.00	4.10	9.00	4.09	9.00	4.54	10.00
1 1/2	6.4	31.8	124.0	4	28.4	1	139.7	133.4	139.7	5.90	13.00	5.45	12.00	5.40	11.90	5.90	13.00
2	7.9	38.1	165.1	8	25.4	7/8	146.1	139.7	146.1	10.89	24.00	9.98	22.00	9.53	21.00	11.34	25.00
2 1/2	7.9	47.8	190.5	8	28.4	1	158.8	152.4	158.8	16.33	36.00	15.80	34.80	13.15	29.00	16.00	35.30
3	9.7	41.1	190.5	8	25.4	3/8	146.1	139.7	146.1	15.00	33.00	11.80	26.00	11.34	25.00	13.17	29.00
4	11.2	47.8	235.0	8	31.8	1 1/8	171.5	165.1	171.5	23.13	51.00	23.20	51.00	22.60	48.50	24.50	54.00
5	11.2	53.8	279.4	8	35.1	1 1/4	190.5	184.2	190.5	38.50	84.90	37.65	83.00	36.74	81.00	39.46	87.00
6	12.7	57.2	317.5	12	31.8	1 1/8	190.5	184.2	196.9	49.89	110.00	48.30	106.50	47.50	104.70	51.50	113.50
8	12.7	63.5	393.7	12	38.1	1 3/8	222.3	215.9	222.3	79.45	175.00	75.00	166.30	86.00	189.60	89.00	106.20
10	12.7	71.4	469.9	16	38.1	1 3/8	235.0	228.6	235.0	118.04	260.00	111.13	245.00	125.64	277.00	131.54	290.00
12	12.7	76.2	533.4	20	38.1	1 3/8	254.0	247.7	254.0	157.00	346.00	146.00	321.80	167.00	368.00	187.00	412.30
14	12.7	82.6	558.8	20	41.1	1 1/2	273.1	266.7	292.1	181.60	400.40	172.36	380.00	180.07	397.00	224.07	494.00
16	12.7	85.9	616.0	20	44.5	1 1/2	285.8	279.4	298.5	224.73	495.50	192.95	425.40	211.11	465.40	272.40	600.50
18	12.7	88.9	685.8	20	50.8	1 3/8	323.9	317.5	333.6	308.72	680.60	272.40	600.50	295.10	650.60	385.90	850.80
20	12.7	91.9	749.3	20	53.8	2	349.3	342.9	362.0	376.82	830.70	331.42	730.60	367.74	810.70	488.00	1076.00
24	12.7	101.6	901.7	20	66.5	2 1/2	438.2	431.8	457.2	685.00	1510.00	632.00	1393.30	700.00	1543.00	905.00	1995.00

- (4) Blind Flanges may be made with the same hub as that used for Slip-on Flanges or without hub.
- (5) The gasket surface and backside (bearing surface for bolting) are made parallel within 1 degree. To accomplish parallelism, spot facing is carried out according to MSS SP-9, without reducing thickness(t).
- (6) Dimensions of size 1/2" through 2 1/2" are the same as for Class 1500 Flanges.

# CLASS 1500 FLANGES

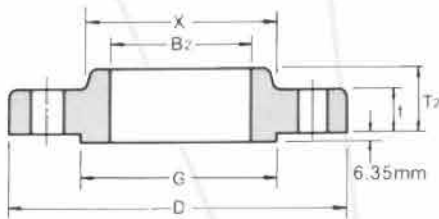

SLIP-ON

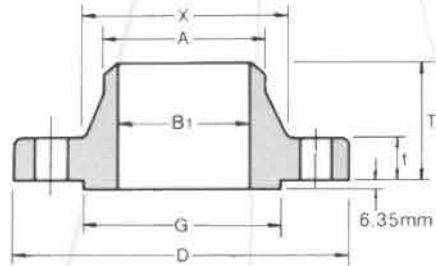

WELDING NECK

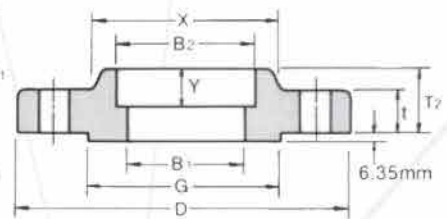

SOCKET WELDING

## ANSI B16.5 FORGED FLANGES

Unit : mm

Nominal Pipe Size	Outside Diam.	Diam. at Base of Hub	O.D. of Raised Face	Thick-ness	BORE				LENGTH THRU HUB			Diam. of Hub at Bevel	Radius of Fillet	Thread Length
					Welding Neck Socket Welding	Slip-on Socket Welding	Lap Joint	Counter Bore Min.	Welding Neck	Slip-on Threaded Socket Welding	Lap Joint			
					B <sub>1</sub>	B <sub>2</sub>	B <sub>3</sub>	B	T <sub>1</sub>	T <sub>2</sub>	T <sub>3</sub>			
½	121	38.1	35.1	22.4	See Note(1) To be specified by purchaser.	22.4	22.9	23.6	60.5	31.8	31.8	21.3	3.0	22.4
¾	130	44.5	42.9	25.4		27.7	28.2	29.0	69.9	35.1	35.1	26.7	3.0	25.4
1	149	52.3	50.8	28.4		34.5	35.1	35.8	73.2	41.1	41.1	33.5	3.0	28.4
1¼	159	63.5	63.5	28.4		43.2	43.7	44.5	73.2	41.1	41.1	42.2	4.8	30.2
1½	178	69.9	73.2	31.8		49.5	50.0	50.5	82.6	44.5	44.5	48.3	6.4	31.8
2	216	104.6	91.9	38.1		62.0	62.5	63.5	101.6	57.2	57.2	60.5	7.9	38.1
2½	244	124.0	104.6	41.1		74.7	75.4	76.2	104.6	63.5	63.5	73.2	7.9	47.8
3	267	133.4	127.0	47.8		90.7	91.4	92.2	117.3	73.2	73.2	88.9	9.7	50.8
4	311	162.1	157.2	53.8		116.1	116.8	117.6	124.0	90.4	90.4	114.3	11.2	57.2
5	375	196.9	185.7	73.2		143.8	144.5	144.5	155.4	104.6	104.6	141.2	11.2	63.5
6	394	228.6	215.9	82.6		170.7	171.5	171.5	171.5	119.1	119.1	168.4	12.7	69.9
8	483	292.1	269.7	91.9		221.5	222.3	222.3	212.9	142.7	142.7	219.2	12.7	76.2
10	584	368.3	323.9	108.0		276.4	277.4	276.4	254.0	158.8	177.8	273.1	12.7	84.1
12	673	450.9	381.0	124.0		327.2	328.2	328.7	282.4	180.8	218.9	323.9	12.7	91.9
14	749	495.3	412.8	133.4		359.2	360.2	360.4	298.5	-	241.3	355.6	12.7	-
16	826	552.5	469.9	146.1		410.5	411.2	411.2	311.2	-	260.4	406.4	12.7	-
18	914	596.9	533.4	162.1		461.8	462.3	462.0	327.2	-	276.4	457.2	12.7	-
20	984	641.4	584.2	177.8		513.1	514.4	512.8	355.6	-	292.1	508.0	12.7	-
24	1168	762.0	692.2	203.2		616.0	616.0	614.4	406.4	-	330.2	609.6	12.7	-

**Notes :**

- (1) For the inside diameter of pipes (corresponding to 'Bore' (B<sub>1</sub>) of Welding Neck Flanges)
- (2) Class 1500 flanges except Lap Joint will be furnished with 0.25" (6.35mm) raised face, which is included in 'Thickness' (t) and 'Length through Hub' (T<sub>1</sub>, T<sub>2</sub>)
- (3) For Slip-on, Threaded, Lap Joint and Socket Welding Flanges, the hubs can be shaped either vertical from base to top or tapered within the limits of 7 degrees.

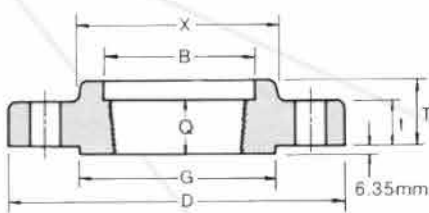

**THREADED**

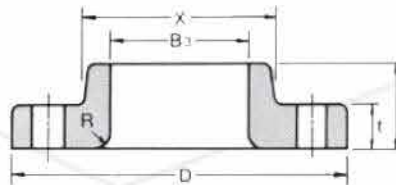

**LAP JOINT**

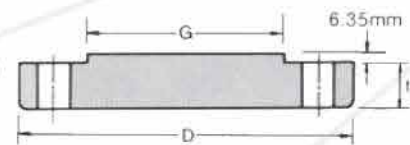

**BLIND**

Unit : mm

Nominal Pipe Size	Depth of Socket Y	DRILLING			BOLTING			APPROXIMATE WEIGHT										
		Bolt Circle Diam	Number of Holes	Diam of Holes	Diam of Bolts (inch)	Stud Bolt Length			Welding Neck		Slip-on and Threaded		Lap Joint		Blind		Socket Welding	
						0.25" Raised Face	Male-Female Tongue-Groove	Ring Joint	Kg	lb	Kg	lb	Kg	lb	Kg	lb	Kg	lb
1/2	9.7	82.6	4	22.4	3/4	108.0	101.6	108.0	2.10	4.60	1.80	4.00	1.80	4.00	1.90	4.00	1.81	4.00
3/4	11.2	88.9	4	22.4	3/4	114.3	108.0	114.3	2.72	6.00	2.27	5.00	2.27	5.00	2.72	6.00	2.81	6.20
1	12.7	101.6	4	25.4	7/8	127.0	120.7	127.0	3.86	8.50	3.40	7.50	3.40	7.50	4.08	9.00	3.61	8.00
1 1/4	14.2	111.3	4	25.4	7/8	127.0	120.7	127.0	4.54	10.00	4.10	9.00	4.09	10.80	4.30	9.50	4.99	11.00
1 1/2	15.7	124.0	4	28.4	1	139.7	133.4	139.7	5.90	13.00	5.45	12.00	5.40	11.90	5.90	13.00	6.76	14.90
2	17.5	165.1	8	25.4	7/8	146.1	139.7	146.1	10.89	24.00	10.50	23.00	9.53	21.00	11.30	25.00	10.89	24.00
2 1/2	19.1	190.5	8	28.4	1	158.8	152.4	158.8	16.34	36.00	15.80	34.80	13.15	29.00	16.00	35.30	16.34	36.00
3	20.6	203.2	8	31.8	1 1/8	177.8	171.5	177.8	21.79	48.00	21.77	48.00	17.24	38.00	21.79	48.00		
4	23.9	241.3	8	35.1	1 1/4	196.9	190.5	196.9	31.30	69.00	31.00	68.40	29.00	63.90	33.11	73.00		
5	23.9	292.1	8	41.1	1 1/2	247.7	241.3	247.7	59.02	130.00	58.80	129.60	54.00	119.00	60.00	132.30		
6	26.9	317.5	12	38.1	1 3/8	260.4	254.0	266.7	74.91	165.00	74.00	163.00	62.00	136.70	75.00	165.30		
8	31.8	393.7	12	44.5	1 5/8	292.1	285.8	323.9	123.83	273.00	117.73	258.00	129.73	236.00	136.98	302.00		
10	33.3	482.6	12	50.8	1 7/8	336.6	330.2	342.9	205.93	454.00	197.49	435.40	220.19	485.40	229.97	507.00		
12	39.6	571.5	12	53.8	2	374.7	368.3	387.4	306.00	674.60	264.00	582.00	286.02	630.60	316.00	696.70		
14	41.4	635.0	16	60.5	2 1/4	406.4	400.1	425.5	416.00	917.00	-	-	404.06	890.80	421.00	928.00		
16	44.5	704.9	16	66.5	2 1/2	444.5	438.2	469.9	567.50	1250.00	-	-	522.10	1151.00	559.00	1232.70		
18	49.3	774.7	16	73.2	2 3/4	495.3	489.0	527.1	736.00	1622.60	-	-	669.65	1476.30	761.00	1677.70		
20	54.1	831.9	16	79.2	3	539.8	533.4	565.2	929.00	2048.00	-	-	805.85	1776.60	967.00	2131.80		
24	63.5	990.6	16	91.9	3 1/2	616.0	609.6	647.7	1504.00	3315.70	-	-	1285.55	2834.00	1568.00	3456.80		

- (4) Blind Flanges may be made with the same hub as that used for Slip-on Flanges or without hub.
- (5) The gasket surface and backside (bearing surface for bolting) are made parallel within 1 degree. To accomplish parallelism, and facing is carried out according to MSS SP-9, without reducing thickness(t).
- (6) Dimensions of size 1/2" through 2 1/2" are the same as for Class 900 Flanges.
- (7) Depth of Socket (Y) is covered by ANSI B16.5 only in sizes through 2 1/2 inch, over 2 1/2 inch is at the manufacturer's option

# CLASS 2500 FLANGES

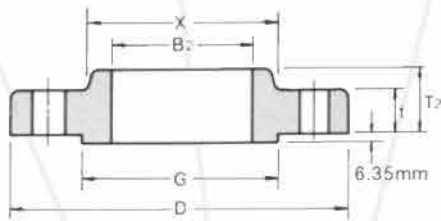

SLIP-ON

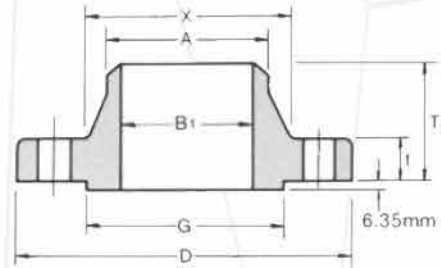

WELDING NECK

## ANSI B16.5 FORGED FLANGES

Unit : mm

Nominal Pipe Size	Outside Diam.	Diam. at Base of Hub	O.D. of Raised Face	Thick-ness	BORE				LENGTH THRU HUB			Diam. of Hub at Bevel	Radius of Fillet	Thread Length	
					Welding Neck	Slip-on	Lap Joint	Counter Bore Min.	Welding Neck	Slip-on and Threaded	Lap Joint				
					B <sub>1</sub>	B <sub>2</sub>	B <sub>3</sub>	B	T <sub>1</sub>	T <sub>2</sub>	T <sub>3</sub>				
D	X	G	t	To be specified by purchaser.											
½	133	42.9	35.1	30.2		22.4	22.9	23.6	73.2	39.6	39.6	21.3	3.0	28.4	
¾	140	50.8	42.9	31.8		27.7	28.2	29.0	79.2	42.9	42.9	26.7	3.0	31.8	
1	159	57.2	50.8	35.1		34.5	35.1	35.8	88.9	47.8	47.8	33.5	3.0	35.1	
1¼	184	73.2	63.5	38.1		43.2	43.7	44.5	95.3	52.3	52.3	42.2	4.8	38.1	
1½	203	79.2	73.2	44.5		49.5	50.0	50.5	111.3	60.5	60.5	48.3	6.4	44.5	
2	235	95.3	91.9	50.8		62.0	62.5	63.5	127.0	69.9	69.9	60.5	7.9	50.8	
2½	267	114.3	104.6	57.2		74.7	75.4	76.2	142.7	79.2	79.2	73.2	7.9	57.2	
3	305	133.4	127.0	66.5		90.7	91.4	92.2	168.1	91.9	91.9	88.9	9.7	63.5	
4	356	165.1	157.2	76.2		116.1	116.8	117.6	190.5	108.0	108.0	114.3	11.2	69.9	
5	419	203.2	185.7	91.9		143.8	144.5	144.5	228.6	130.0	130.0	141.2	11.2	76.2	
6	483	235.0	215.9	108.0		170.7	171.5	171.5	273.1	152.4	152.4	168.4	12.7	82.6	
8	552	304.8	269.7	127.0		221.5	222.3	222.3	317.5	177.8	177.8	219.2	12.7	95.3	
10	673	374.7	323.9	165.1		276.4	277.4	276.4	419.1	228.6	228.6	273.1	12.7	108.0	
12	762	441.5	381.0	184.2		327.2	328.2	328.7	463.6	254.0	254.0	323.9	12.7	120.7	

**Notes :**

- (1) For the inside diameter of pipes (corresponding to 'Bore' (B<sub>1</sub>) of Welding Neck Flanges),
- (2) Class 2500 flanges except Lap Joint will be furnished with 0.25" (6.35mm) raised face, which is not included in 'Thickness' (t) and 'Length through Hub' (T<sub>1</sub>), (T<sub>2</sub>)
- (3) For Slip-on, Threaded and Lap Joint Flanges, the hubs can be shaped either vertical from base to top or tapered within the limits of 7 degrees.

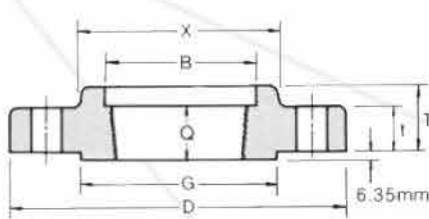

**THREADED**

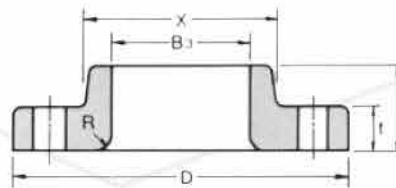

**LAP JOINT**

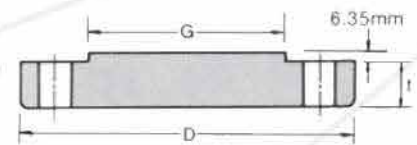

**BLIND**

Unit : mm

Nominal Pipe Size	DRILLING			BOLTING				APPROXIMATE WEIGHT							
				Stud Bolt Length				Welding Neck		Slip-on and Threaded		Lap Joint		Blind	
	Bolt Circle Diam.	Number of Holes	Diam. of Holes	Diam. of Bolts (inch)	0.25" Raised Face	Male-Female Tongue-Groove	Ring Joint	Kg	lb	Kg	lb	Kg	lb	Kg	lb
1/2	88.9	4	22.4	3/4	120.7	114.3	120.7	3.18	7.00	3.18	7.00	3.00	6.60	3.18	7.00
3/4	95.3	4	22.4	3/4	127.0	120.7	127.0	4.08	9.00	4.08	9.00	3.63	8.00	4.54	10.00
1	108.0	4	25.4	7/8	139.7	133.4	139.7	5.45	12.00	5.44	12.00	4.99	11.00	5.44	12.00
1 1/4	130.0	4	28.4	1	152.4	146.1	152.4	9.07	20.00	8.16	18.00	7.26	16.00	8.16	18.00
1 1/2	146.1	4	31.8	1 1/8	171.5	165.1	171.5	11.35	25.00	11.00	24.30	9.99	22.00	10.44	23.00
2	171.5	8	28.4	1	177.8	171.5	177.8	19.07	42.00	17.25	38.00	16.80	37.00	17.71	39.00
2 1/2	196.9	8	31.8	1 1/8	196.9	190.5	203.2	23.61	52.00	24.97	55.00	24.06	53.00	25.42	56.00
3	228.6	8	35.1	1 1/4	222.3	215.9	228.6	42.68	94.00	37.68	83.00	36.32	80.00	39.04	86.00
4	273.1	8	41.1	1 1/2	254.0	247.7	260.4	64.00	141.00	58.00	127.90	54.48	120.00	60.38	133.00
5	323.9	8	47.8	1 3/4	298.5	292.1	311.2	110.68	244.00	95.25	210.00	92.53	204.00	101.15	223.00
6	368.3	8	53.8	2	342.9	336.6	355.6	176.46	378.00	146.51	323.00	143.01	315.30	156.63	345.30
8	438.2	12	53.8	2	381.0	374.7	393.7	261.27	576.00	219.99	485.00	213.38	470.40	240.62	530.50
10	539.8	12	66.5	2 1/2	489.0	482.6	508.0	484.43	1068.00	419.57	925.00	408.60	900.80	465.36	1026.00
12	619.3	12	73.2	2 3/4	539.8	533.4	558.8	692.35	1526.30	590.20	1301.00	572.95	1263.00	664.06	1464.00

(4) Blind Flanges may be made with the same hub as that used for Slip-on Flanges or without hub.

(5) The gasket surface and backside (bearing surface for bolting) are made parallel within 1 degree. To accomplish parallelism, spot facing is carried out according to MSS SP-9, without reducing thickness(t).

(6) Class 2500 Slip-on Flanges are not covered by ANSI B16.5, slip-on flanges are at the manufacturer's option